

IMPORTANT!

Instructions for applying **KAMAR® QuickStick™ Heatmount® Detectors**

1 Prepare the cow:

- Select an appropriate application area slightly behind the hips.
- Wipe and dry the area as needed. A clean, dry site will help adhesion (fresh manure, shedding hair, and excess oil will interfere with strong adhesion). If in doubt, apply some KAMAR adhesive to the application site.

2 Remove the protective backing:

- Roll back side of detector to separate backing at the score.
- Take care to remove and dispose of the backing in one piece.

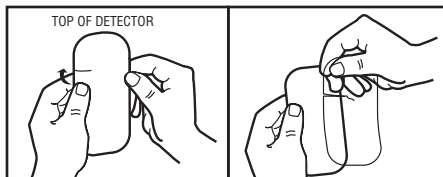

3 Apply the Kamar QuickStick Detector:

- With the arrow pointed toward the cow's head, firmly press the detector onto the hair slightly behind the hips, not at the tailhead. DO NOT ATTEMPT TO RE-POSITION.
- Vigorously rub the cloth into the hair for a few seconds to maximize adhesion.

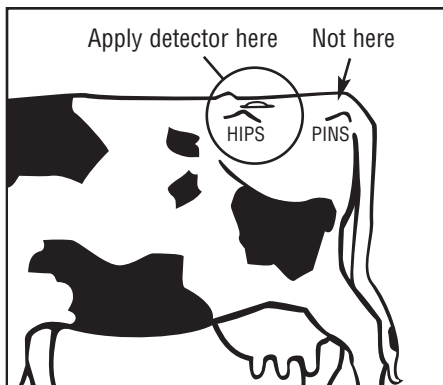

4 Observe cows:

- Triggered detectors, dislodged detectors, soiled detector cloth, and rubbed pins may all be indicators of estrous behavior.